

Park Hall Academy

Carberry Way, Weston Coyney, ST3 5QU

Telephone: 01782 312384

Attendance Line: 01782 342521

Email: parkhall@parkhallprimary.org.uk

Principal: Mrs G. Frost

Continuing The Learning Journey Together



zoom



showbie

Parents/Carers

To begin on behalf of team Park Hall I just want to say what an amazing job you are already doing at homeschooling your children. This is an incredibly difficult journey for us all. The children will treasure this special time at home with you forever and rest assured we can't wait to take over and be teaching the children in the classroom again.

We value feedback regarding home learning and we want to make things as easy as possible for you. In years 1-6 the children use an app called 'Showbie' both in school and at home. This app has proved to be a valuable resource for remote learning. We understand the importance of your children having face-to-face engagement with their class teachers and peers. Using showbie and zoom will enable this to happen. This guide below should answer any FAQs and provide you with support to access these platforms. If you have any further queries please email your class teacher who will support you.

Showbie

All children years 1-6 completing any form of remote learning at home will have access to their school iPad. If you have not collected the school iPad you can use an iPad at home download the showbie app from your app store. If you have a tablet/laptop/computer go to www.showbie.com

1. Your class teacher has sent your login details and class code for Spring. If you have a school iPad open the app. If you do not go to this web address

www.showbie.com and select 'sign in' it is really important you tap SIGN IN not sign up.

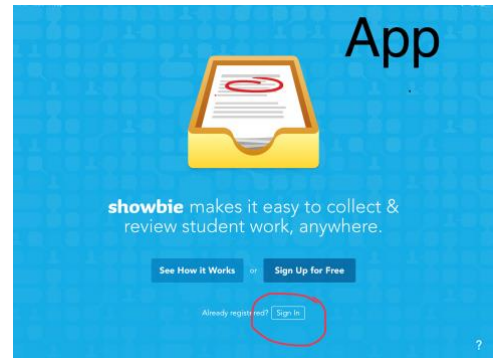
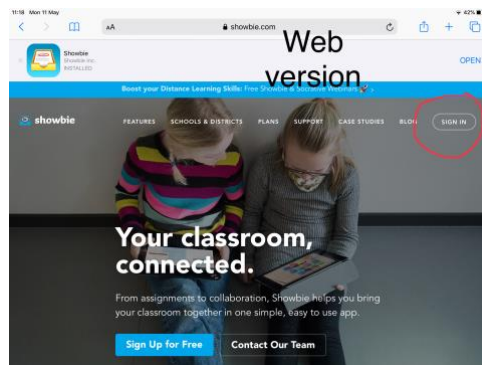

2. Enter your username and password and then select 'join class' and enter the class code sent to you via text.

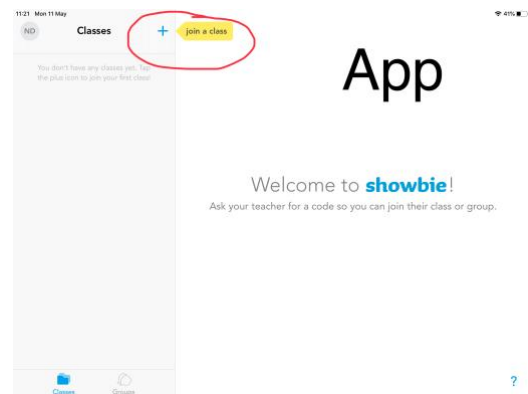
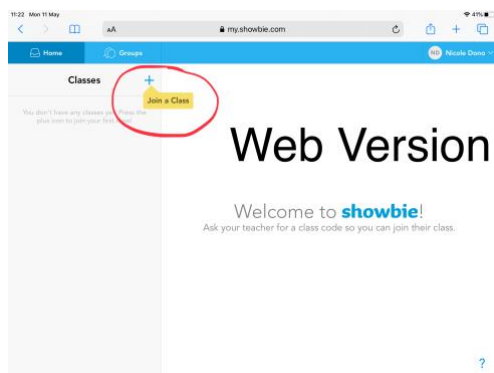

3. Once you select your class you should then be able to see subject folders down the left hand side

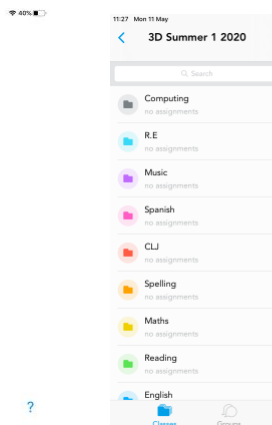
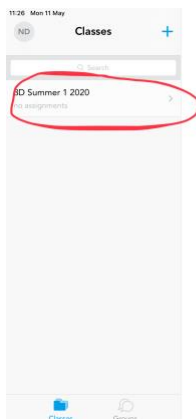

- Each day you will need to navigate to the 'Remote Learning' folder. In here you will find a daily schedule that will direct you to the correct folders on showbie for each lesson.

5. Class teachers will direct you to corresponding subject folders where you will find activities/videos to watch/complete.

For example on your schedule it may say 'navigate to the Maths folder and watch Video 1 then complete the Dividing by 100 worksheet.'

To find the activity go back to your class section and navigate to the appropriate subject folder. For this activity it would be Maths. Then select the corresponding video/activity.

Repeat this same process for any subject folder you are navigated to on your home learning schedule.

- If your child has access to an iPad/tablet-** Once you select a task your child will then be able to edit this document on their iPad/tablet. Following the above example, once you select the correct activity the document will then open and you can use the tools at the top of the document to edit it

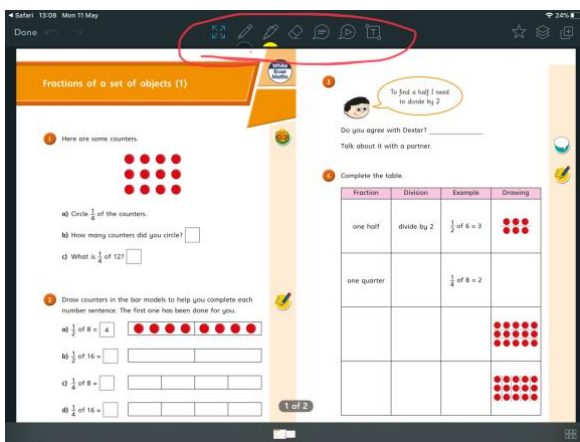

There are options to highlight, draw, erase, add text and others. The main tool you would need for this activity < is the pen tool (second on the left) to fill in the correct answers. Double press on a tool to open more options e.g. Colours and pen thickness. Pinch to zoom in/out on the document like you would on a phone.

Once you have finished editing a document you simply need to press 'done' in

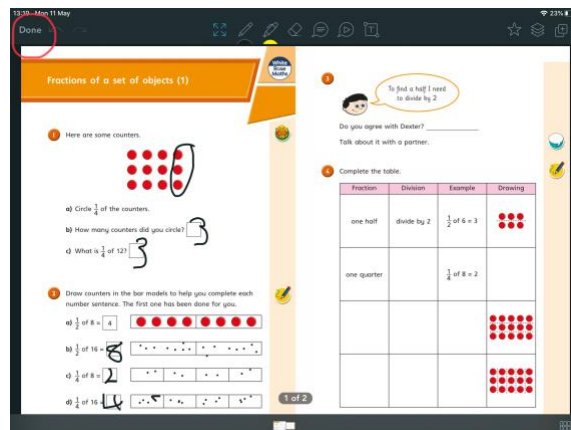

the top left corner and your annotations will be saved for your teacher to see.

7. If you do not have an iPad/tablet at home and are using a web browser - Follow the same steps as above ^^ however depending on what device you are using your editing options may be limited. Please do not worry if you can't edit a document. See instructions below about uploading screen shots/photographs.

8. Your teacher may set a creative activity that you want to take a photograph of and upload it to showbie for them to see. You could also do this if you don't have an iPad/tablet and your editing options are limited on a web browser. Take a photograph of your work using the same device you are using showbie on.

Find the correct subject folder and corresponding week on showbie

Then select the '+' symbol and choose 'photo library and upload the relevant photo

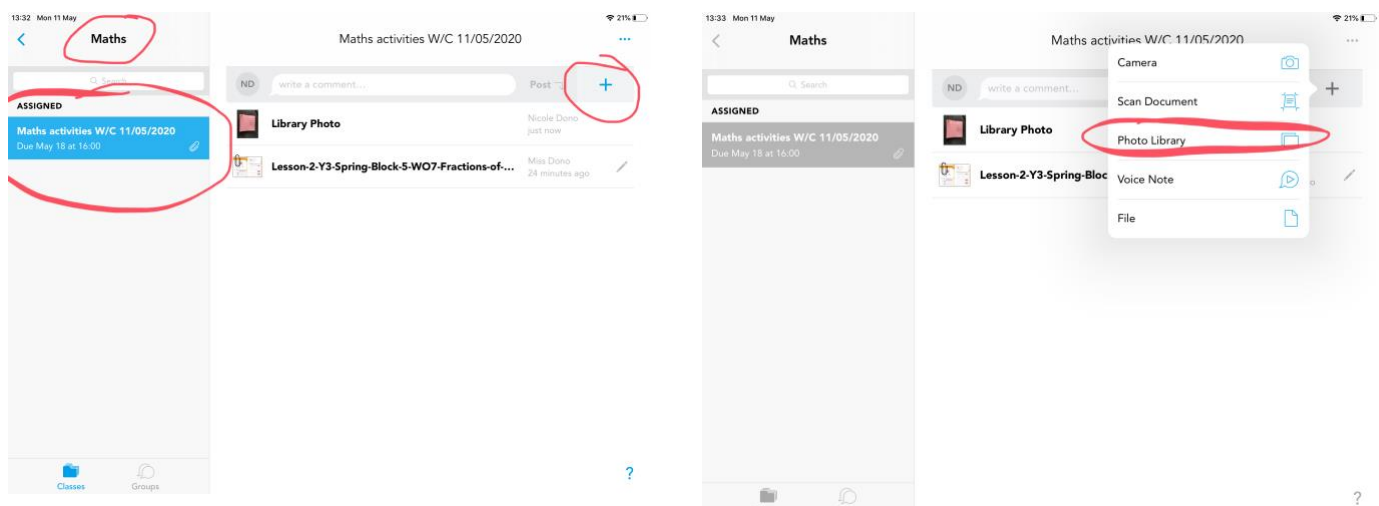

9. Staff will be providing feedback to pupils via showbie. You will know which piece of work your teacher has marked as a little red symbol will appear next to the paper clip. Once you select the document you may see your teacher has highlighted your work. You may see a small cartoon picture of them appear with a comment they have left for you. They may even leave you a voice note.

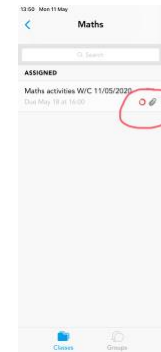

Zoom

Each week your child will be invited to a Live Celebration Assembly and a Live Lesson. These will take place over Zoom. On your Daily Schedule you will see an invite link which looks like the example below. You need to download the zoom app. This will already be downloaded on the school iPads.

Mrs Preston is inviting you to a scheduled Zoom meeting.

Topic: Celebration Assembly

Time: Jan 8, 2021 03:00 PM London

Join Zoom Meeting

<https://us02web.zoom.us/j/85073717206?pwd=TnNqOXZkUVhELytWYmJFYXh6M3JLUT09>

Meeting ID: 851 7371 7206

Passcode: FLjyk8

Open the app and tap on 'join a meeting'

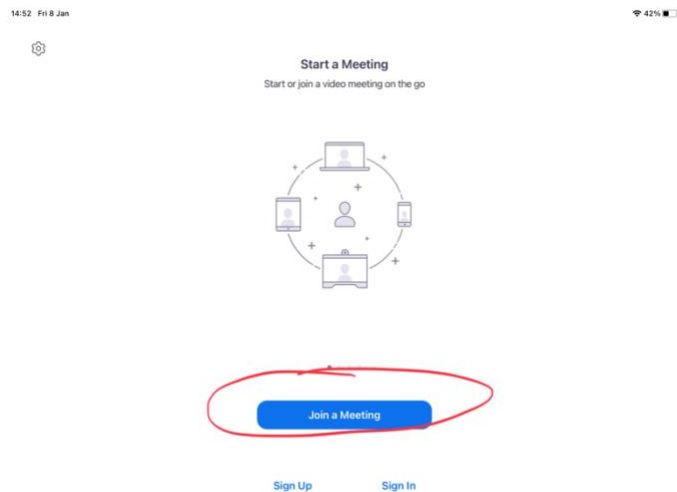

Then enter the 'meeting ID' which will be shared with you on your daily schedule as above ^

Enter your child's name

And make sure the bottom two toggles are switched off

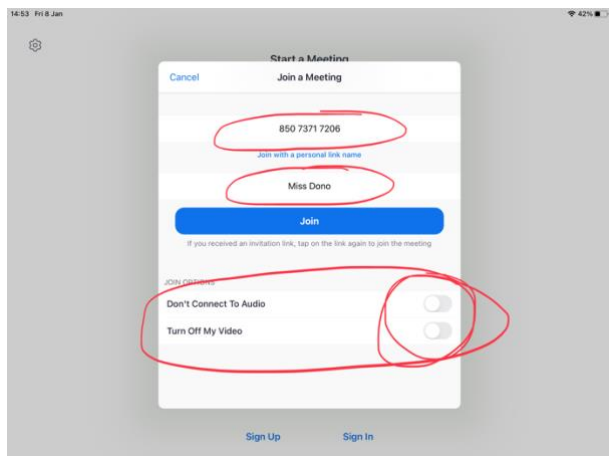

You then need to add the meeting password which will be shared with you on your daily schedule as above ^

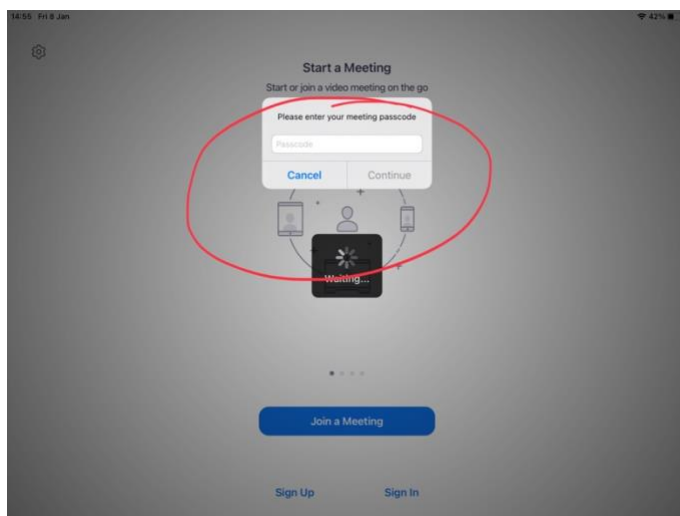

You will then see the waiting room where your teacher will admit you to the lesson/assembly

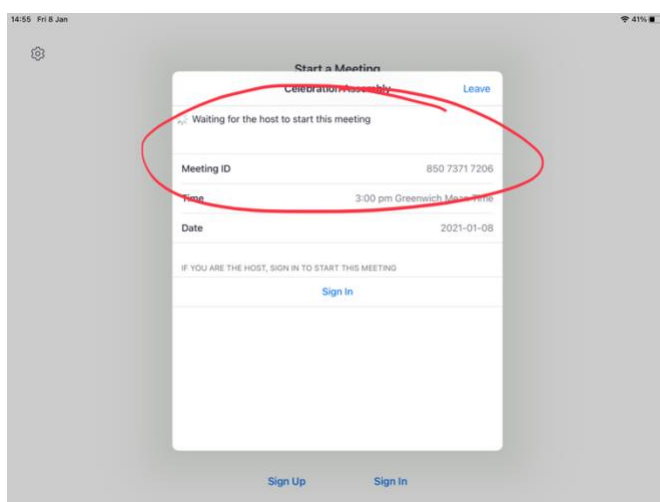

Logitech Crayons

If you find your child's Logitech crayons stop working the nibs can often be loose. Please watch the video link below which shows you how to replace a nib. You won't need to replace it but you will see on the video how to ensure the nib is screwed in tightly

<https://www.youtube.com/watch?v=8pdULwak2Ic>

If you have any queries please email your class teacher directly. Staff will be able to respond to this quicker and more efficiently than on the Park Hall facebook page.

Finally I hope you all are safe and well and look forward to seeing you all soon.

Miss Dono
Director of Innovation

Our Values Are At The HEART Of Everything We Do

